

# QUIET PARADE Townhall

May 9, 2024, 1-2:30pm

UTM Council Chambers, Davis Building 3130

## Directions and Accessibility

### Directions to the University of Toronto Mississauga

#### Via shuttle from University of Toronto St. George Campus

Students with a valid UTM student ID card are eligible to travel free of charge. Non students must purchase a ticket from the Porter's Desk at Hart House or from the Student Centre at UTM. Tickets are \$7.00 each way. Click [here](#) for the shuttle bus schedule and more information.

#### Via TTC/MiWay

MiWay buses depart from Kipling subway station for UTM approximately every 10-15 minutes. All Mississauga Transit buses accept payment by cash and Presto card. For exact times and fares, please visit the [MiWay](#) website.

*There are two options:*

1. On weekdays from 6:30am–8pm you can take the **101A Dundas Express West via UTM**. The ride takes about 45 minutes.
2. At other times of the day or on weekends, you can take the **1C West** bus, which takes the same route, but makes all the stops. The ride takes about 55 minutes. This bus runs until midnight.

#### Via GO Train / Bus

The Clarkson GO Train station is the easiest way to access the campus by train. From the station, the 110N MiWay express bus departs regularly for the UTM campus. All Mississauga Transit buses accept payment by cash and Presto card. For routes, schedules and fares, please visit the [GO Transit](#) website. For bus fares and times, please visit the [MiWay](#) website.

#### By Car

From Toronto, visitors may take the Gardiner Expressway to the Queen Elizabeth Way (QEW) westbound. Exit the highway at Mississauga Road and turn north as indicated by the signs. Continue traveling along Mississauga Road North for approximately 9 minutes. Upon crossing Dundas St., UTM campus is on the right hand side.

## Campus Map with Parking and Transit information:

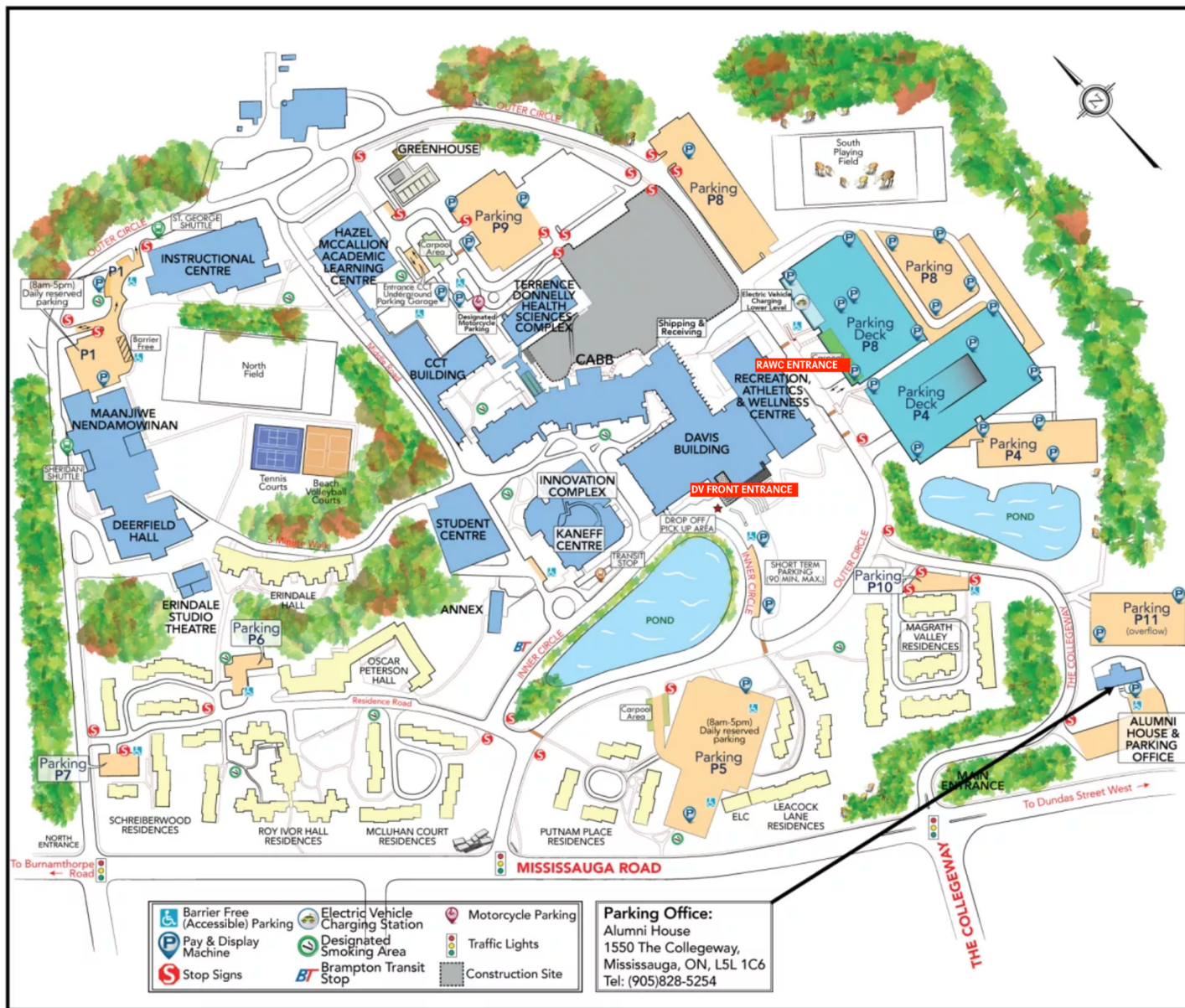

**Barrier-free parking spaces** are available for those who have a Provincial Ministry of Transportation Accessible Parking Permit (APP). Accessible parking areas closest to the UTM Council Chambers are on Inner Circle Road (90 minute maximum) adjacent to the Davis Building Front Entrance and in Parking Deck P8 adjacent to the RAWC (gym) Entrance. For more information on barrier-free parking at UTM, [click here](#).

## Directions to UTM Council Chambers, Davis Building 3130:

### If entering from the RAWC (gym) entrance:

- Enter doors (labelled RAWC Entrance on map).
- Proceed up the stairs immediately inside the doors or pass the stairs inside the RAWC entrance, continuing straight down the hall to the elevator at the end of the hall, no turning is required. Ride the elevator to the third floor.

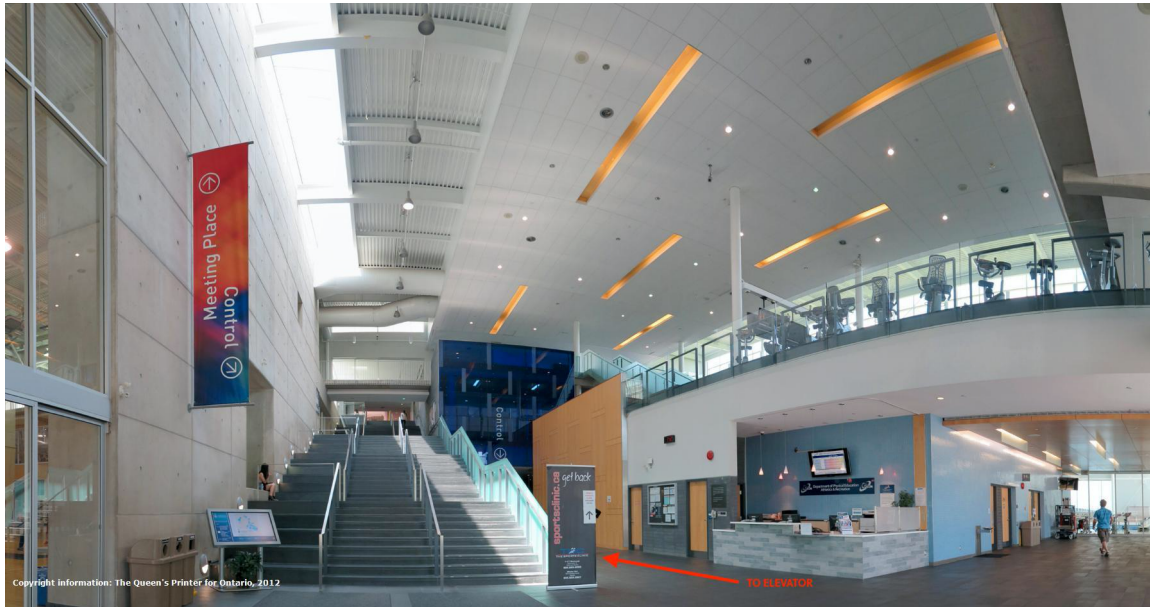

- At the top of the staircase, walk past the meeting place and Tim Horton's to the staircase on the right-hand side beside Tim Horton's. Follow the stairs up to the top and go through the doors to the third floor.
- Once on the third floor, continue down the hallway indicated by the arrow in the photo below. If you have taken the elevator (labelled "E" below), the hallway is on the right; if you have taken the stairs (labelled "S" below), continue straight. Pass the bank of windows on the left.





- Once you pass the bank of windows, turn down the corridor to your left and then the Council Chambers hallway on your right. There is a small sign that says 3130 on the wall to the left of the entrance.



**If entering from the Davis Building front entrance:**

- Enter doors into the meeting place/cafeteria (labelled DV Front Entrance on the map).
- Walk through the meeting place until you reach the staircase that is beside Tim Horton's. There is an elevator on the left-hand wall that is parallel to the stairs.
- Take the elevator/stairs to the third floor and then follow the instructions above for how to navigate down the hallway to the Council Chambers.



## Physical Access and Facilities



The Council Chambers is located on the third floor of the Davis Building. All entrances at ground floor level to the Davis Building are equipped with power-assisted doors. The Council Chambers is accessible to people who use mobility devices, with elevator access, doorways measuring over 32" wide, and an automatic door opener. It is an open, flat space with many windows and a large central table surrounded by movable chairs. An accessible, re-usable water fountain is located between the top of the stairs and elevator on the third floor. Single user, all-gender washrooms are located in the Davis Building on the ground and third floors in rooms: 0116, 3224, 3288.